

CERTIFIED RECORD OF LAND CORNER MONUMENTATION

J-19

History of original corner establishment:

1884, Herman D. Gradon, under contract No. 499, established the corner. He set a wood post, 3' long by 3" square, 24" in the ground, from which:

- 8" Pine bears, N. 82° W., 278 lks.
- 9" Pine bears, S. 42° W., 200 lks.

1983, William R. Wells, PLS 1106, in Grant County Map Survey No. 836, found the NW BT:

- 20" Pine snag bears, N. 82° W., 248 lks., with open blaze and visible scribing.
- Using record bearing and distance from the found BT, Well's reset the corner using a 2 1/2" by 30" aluminum pipe, with 2 1/2" aluminum cap, set 24" in the ground with a mound of stone to the cap, from which:
- Reference monument, 1 1/2" aluminum cap on 5/8" rebar bears, S. 59 1/2° W., 12.00 feet.
- Reference monument, 1 1/2" aluminum cap on 5/8" rebar bears, N. 23 1/2° W., 12.00 feet.

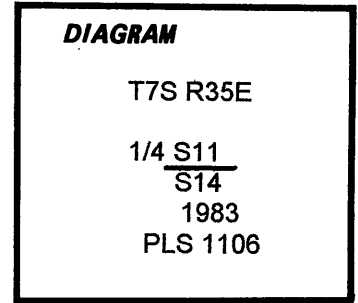

Description of corner evidence found:

Found a 2 1/2" aluminum pipe with 2 1/2" aluminum cap, projecting 4" out of the ground set in a ring of rocks, from which:

- 16" Lodgepole pine snag, 6' high, bears, N. 83 1/2° W., 183.5 feet, scribing "4SB" visible on chopped open blaze.
- 5/8" rebar, with 1 1/2" aluminum cap, projecting 2 1/2" out of the ground bears S. 55°26' W., 12.03 feet, stamped "S14 12.00 FT 1106", with arrow pointing toward the corner.
- 5/8" rebar, with 1 1/2" aluminum cap, projecting 1 1/2" out of the ground bears N. 25°02' W., 11.94 feet, stamped "S11 12.00 FT 1106", with arrow pointing toward the corner.

Description of monument and accessories established to perpetuate the original location of this corner:

Established New References:

- 6" Lodgepole Pine bears, S. 17° W., 106.6 feet, scribed "1/4 S14""BT" on double blaze with a brass washer stamped "RLS 2308" nailed to the lower blaze by the "BT" scribing.
- 5/8" by 24" rebar, with 1 1/2" aluminum cap, set 22" in the ground bears, S. 88°09' E., 52.43 feet, stamped "USDA-FS S11 52.43 FT 2308", with arrow pointing toward the corner.

Magnetic Declination: 20° East

Worked performed by: David A. Schlaich (RLS 2308)
Date: October, 1993

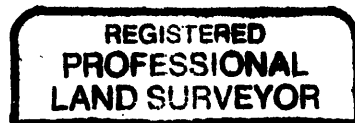

David A. Schlaich

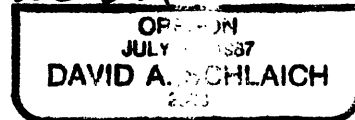

Expires 12/31/94

Office of Surveyor County of Grant
 State of Oregon, I hereby certify that the within instrument was filed in this office
 for record on the 2 day of Feb, 1994
Robert D. Beget by _____
 (COUNTY OFFICIAL) (DEPUTY)

J-19

SEE MDS 1307